

GENERAL NOTES:
 REFERENCE: CALIFORNIA CODE OF REGULATIONS, TITLE 25, SEC 1371 (DEC 29, 2005).

- DESIGN LOADS SHALL BE CONSISTENT WITH LOCAL REQUIREMENTS WHERE INSTALLED.
- ALL FOOTINGS TO BE SUPPORTED BY EITHER FIRM, UNSATURATED, UNDISTURBED SOIL, COMPACTED FILL, ASPHALT OR CONCRETE. FOOTINGS ARE DESIGNED FOR 1000 PSF BEARING CAPACITY AND SHALL BE COMPATIBLE WITH LOCAL SOIL CONDITIONS. ALL FOOTINGS SHALL BE FOUNDED IN ACCORDANCE WITH H.C.D. GUIDELINES AND TITLE 25.
- STRUCTURAL STEEL:
 - SHALL CONFORM TO ASTM A36 Fy = 36 KSI MINIMUM.
 - SHALL BE FABRICATED ACCORDING TO AISC SPECIFICATIONS.
 - SHALL BE WELDED ACCORDING TO AWS SPECIFICATIONS:
 - ELECTRODES: E70
 - PLATES: ASTM A36
 - BOLTS: STANDARD ASTM A307
 - THREADED ROD: COLD DRAWN LOW CARBON WELDABLE
 - ALL METAL COMPONENTS INCLUDING NAILS & SCREWS ETC. ARE TO BE PROTECTIVE COATED.
- THE C.P. SEISMIC PIER SHALL BE LISTED & LABELED BY BSK ASSOCIATES FOR THESE ULTIMATE LOADS:
 - 7 THRU 18 INCH PIERS: 3203 LBS. (STRONG DIR), 2273 (WEAK DIR), 16,000 VERTICAL
 - 19 INCH X-LARGE PIER: 1553 LBS. (STRONG DIR.) 1462 (WEAK DIR), 16,000 VERTICAL
- THIS BRACING SYSTEM IS FOR PLACING MANUFACTURED HOMES CONSTRUCTED WITH LONGITUDINAL OR CROSS JOINTS.
- THIS BRACING SYSTEM PLAN IS DESIGNED TO BE CONSTRUCTED ON A FAIRLY LEVEL SITE WITH NO EXISTING SOIL PROBLEMS. SEE TITLE 25 SECTION 1334(d)
- STANDARD PIER & FOOTING SPACING PER THE HOME MANUFACTURER'S INSTALLATION MANUAL WITHOUT MANUAL, SPACING OF STANDARD PIERS TO BE DETERMINED BY TITLE 25 SECTION 1335.5.

FOUNDATION PAD NOTES:

- TWO FOUNDATION PADS ARE AVAILABLE FOR USE WITH THIS SYSTEM. THE CUSTOMER MAY CHOOSE ONE OF THE PADS FOR THEIR HOME.
- FDTN PADS SHALL BE PLACED ON FIRM, LEVEL UNDISTURBED SOIL (SEE GEN. NOTE 2)
- THE FOUNDATION PADS SHALL BE ORIENTED AS SHOWN ON THE PLAN VIEW DRAWING WITH THE BOLT HOLES PERPENDICULAR TO THE CHASSIS BEAM. SEE PLAN VIEW.
- CONCRETE FOUNDATION PADS
 - 2500 PSI AT 28 DAYS AS TESTED AND MANUF. BY STARLITE WEIGHT CONCRETE.
- PRESSURE TREATED FOUNDATION PAD
 - 3/4 INCH A.P.A. 48/24 EXTERIOR P.S.I.-83 CC. PLUGGED, NER-QA397,PRP-108.
- ATTACHMENT TO EXISTING CONCRETE SLAB
 THE C.P. SEISMIC PIER MAY BE ATTACHED TO AN EXISTING COMPETENT CONCRETE SLAB OR CONCRETE FOOTING ACCORDING TO THE FOLLOWING CRITERIA:
 - ATTACH WITH TWO 1/2" DIA. ITW RAMSET/ REDHEAD TRUBULT WEDGE ANCHORS
 - MINIMUM EMBEDMENT = 2.6"
 - MINIMUM CONCRETE THICKNESS = 3 3/4"
 - MINIMUM EDGE DISTANCE = 2"

HOME SIZE NOTES:

- UNLESS APPROVED BY ROCK SOLID ENGINEERING, INC., THE ROOF PITCH SHOULD NOT EXCEED 4:12 (H:V).
- FOR ANY HOME SIZE OTHER THAN AS SHOWN ON THIS PLAN OR REFERENCED ABOVE, LAYOUT SHALL BE REVIEWED AND APPROVED BY ROCK SOLID ENGINEERING.

INSPECTION REQUIREMENTS:

- THE DESIGN OF THIS SYSTEM IS BASED ON STANDARD MANUFACTURED HOMES AS BUILT BY THE MANUFACTURER. SITE BUILT ADDITIONS SUCH AS GARAGES AND SECONDARY ROOFS HAVE NOT BEEN INCLUDED IN THIS DESIGN.
- ALL DIMENSIONS INCLUDED ON THIS PLAN, INCLUDING COACH SIZE, ROOF HEIGHT AND PIER HEIGHT, SHOULD BE FIELD VERIFIED BY THE LOCAL BUILDING OFFICIAL. ANY DISCREPANCIES SHOULD BE IMMEDIATELY BROUGHT TO THE ENGINEER'S ATTENTION.
- THE BUILDING PAD SHOULD BE INSPECTED TO ENSURE THAT PROPER PAD PREPARATION AND DRAINAGE PATTERNS HAVE BEEN ESTABLISHED IN ACCORDANCE WITH TITLE 25 & MANUFACTURER.

INSTALLATION INSTRUCTIONS

- MARK CHASSIS BEAM ACCORDING TO REQUIRED SPACING.
- FOUNDATION FOR CHASSIS BEAM SUPPORTS SHALL BE LOCATED AND SIZED FOR THE LOADS AS SHOWN IN THE MANUFACTURED HOME INSTALLATION INSTRUCTIONS.
- ALL MANUFACTURER REQUIRED PADS AND PIERS, EXCEPT MASONRY BLOCKS, MUST BE ATTACHED TO CHASSIS BEAM AND FOOTING PAD.
- LEVEL THE SOIL AND FOUNDATION PAD BELOW MARKING AS PER LAYOUT, THIS SHEET AND MANUFACTURER'S INSTALLATION MANUAL.
- ASSEMBLE C.P. SEISMIC PIER TO ITS LOWEST SETTING; PLACE IT ON THE FOUNDATION PAD AND ATTACH IT PER THE CORRESPONDING DETAIL, THIS SHEET.
- RAISE TOP SECTION OF C.P. SEISMIC PIER UNTIL IT TOUCHES BOTTOM OF CHASSIS BEAM BY TURNING PIPE (FOUR TURNS EQUALS ONE INCH CHANGE IN HEIGHT) TIGHTEN FOUR CLAMP BOLTS FIRMLY.
- CLAMP UPPER PLATE TO BOTTOM OF CHASSIS BEAM AS PER DETAIL THIS SHEET.

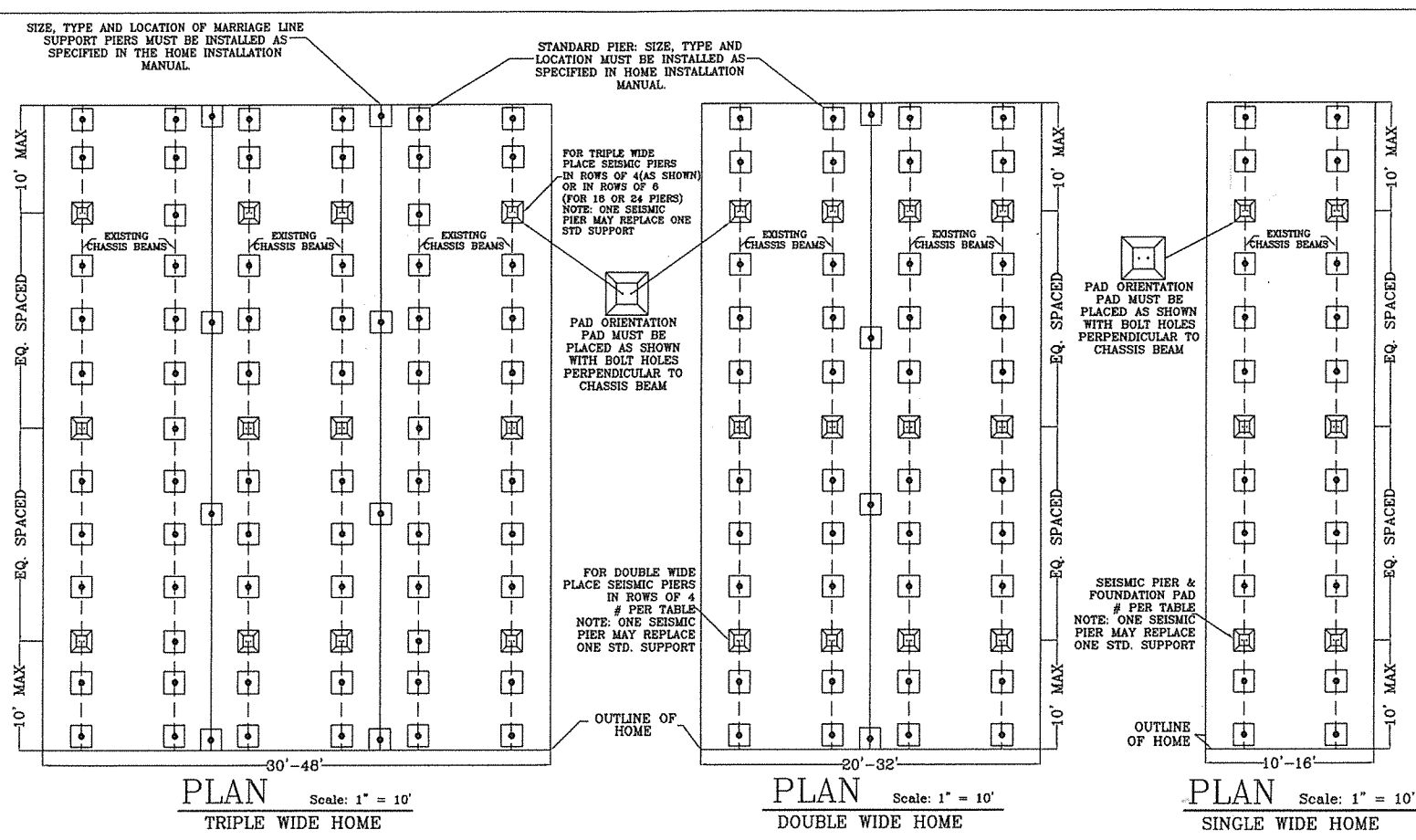

	SEISMIC ZONE 3 & 4		3	
	MAX. SNOW LOAD	# OF SEISMIC PIERS	MAX. SNOW LOAD	# OF SEISMIC PIERS
DOUBLE WIDES	UP TO 44 FT	8	8	12
	44.5 TO 60 FT	12	12	16
	60.5 TO 78 FT	16	16	20
TRIPLE WIDES	UP TO 44 FT	12	12	18
	44.5 TO 60 FT	12	16	18
	60.5 TO 78 FT	12	18	24

	SEISMIC ZONE 3 & 4		3		3 & 4	
	MAX. SNOW LOAD	# OF SEISMIC PIERS	MAX. SNOW LOAD	# OF SEISMIC PIERS	MAX. SNOW LOAD	# OF SEISMIC PIERS
SINGLE WIDES	UP TO 44 FT	4	4	4	6	6
	44.5 TO 60 FT	6	6	6	8	8
	60.5 TO 78 FT	8	8	8	10	10
SINGLE WIDES	UP TO 44 FT	4	6	6	6	6
	44.5 TO 60 FT	6	6	6	8	8
	60.5 TO 78 FT	8	8	8	10	10

STATE APPROVAL

MOBILEHOME EARTHQUAKE BRACING SYSTEM CERTIFICATION

THIS SYSTEM IS CERTIFIED AS BEING LISTED & APPROVED BY A DEPARTMENT APPROVED LISTING OR TESTING AGENCY PURSUANT TO THE C.A.C. TITLE 25 CHAPTER 2. CERTIFICATION DOES NOT AUTHORIZE OR APPROVE ANY OMISSION OF DEVIATION FROM REQUIREMENTS OF APPLICABLE STATE LAWS OR REGULATIONS.

STATE OF CALIFORNIA
 DEPARTMENT OF HOUSING & COMMUNITY DEVELOPMENT
 DIVISION OF CODES & STANDARDS

BY: *[Signature]*
 DATE: 12/2/08
 EXPIRES: 12/2/11

